

## Getting The iBoardTouch Serial Numbers For Warranty Registration

To register for warranty the correct model and serial numbers must be provided to iBoardTouch via the registration form.

The diagram below shows where the relevant information is on the board:

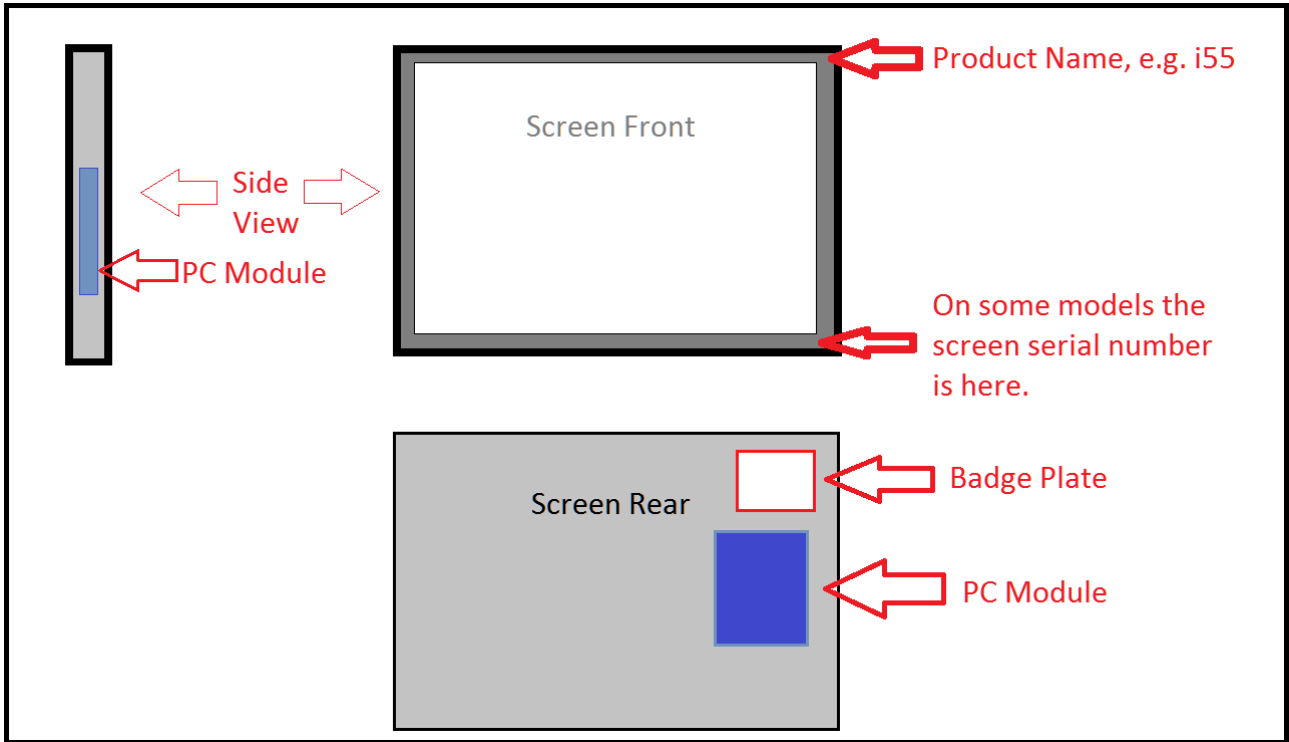

## Board (Screen) Serial Number

The Screen Model & Serial Numbers are found on the badge plate on the back of the screen:



These can also be found on the box in which the screen was packaged:



The Model Number is not the number printed at the front on the top right corner, this is the Product Name:

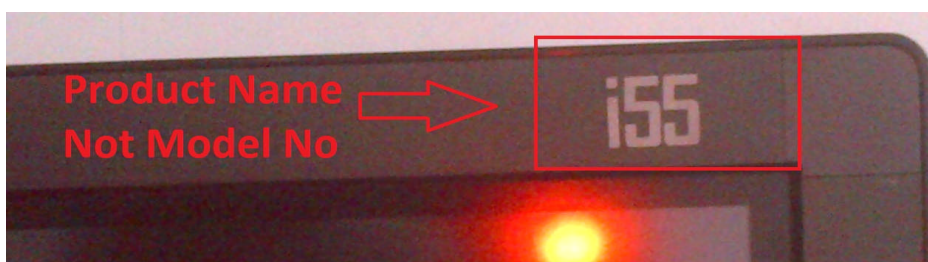

## PC Module Serial Number

For Pro-Packs, the screens come with an integrated PC Module. This module slides into the left side (as you view the screen). The PC Module Serial Number is on a label on the inside edge of the module, meaning that to access it the module must be pulled out.

The PC module will be locked in with a lock screw or on some models with two thumb screws.



Undo the screw(s) and gently pull the module out. On one of the inside edges there will be a label with the serial number starting "MT0". Depending on the model/type, it should look like one of the pictures below:

